

Android

1. Select Settings
2. Select the wi-fi network you want to connect to and hold your finger for a few seconds

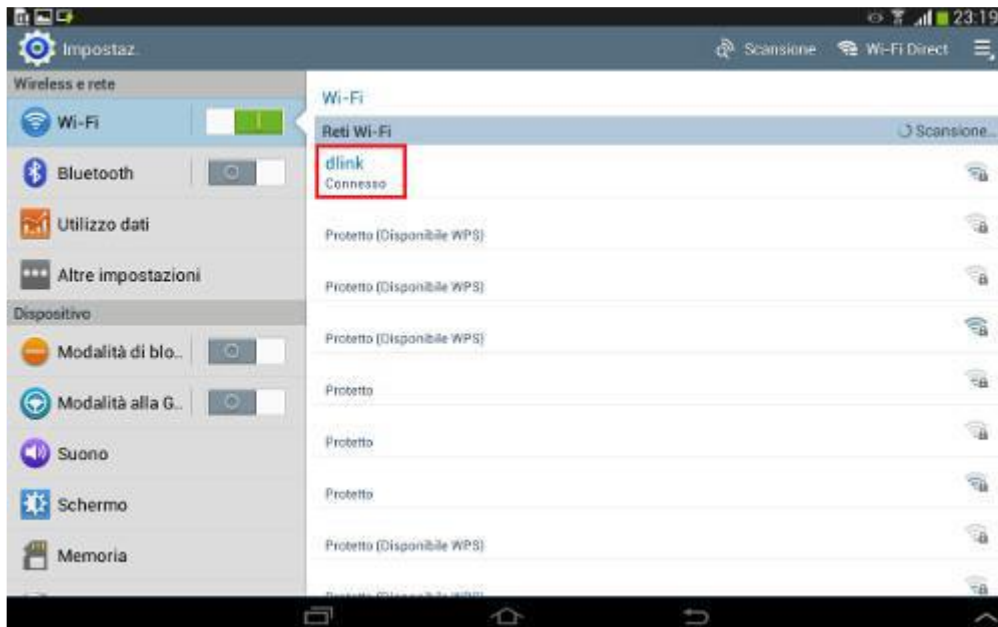

3. Select Change network configurations

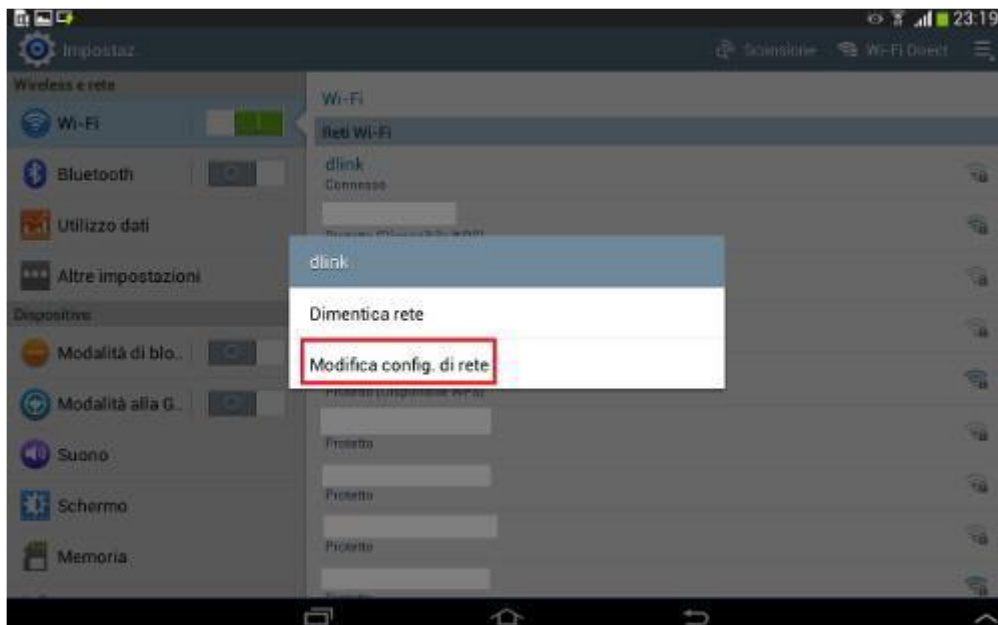

4. If it asks for your password, enter it and then select “Show advanced options”

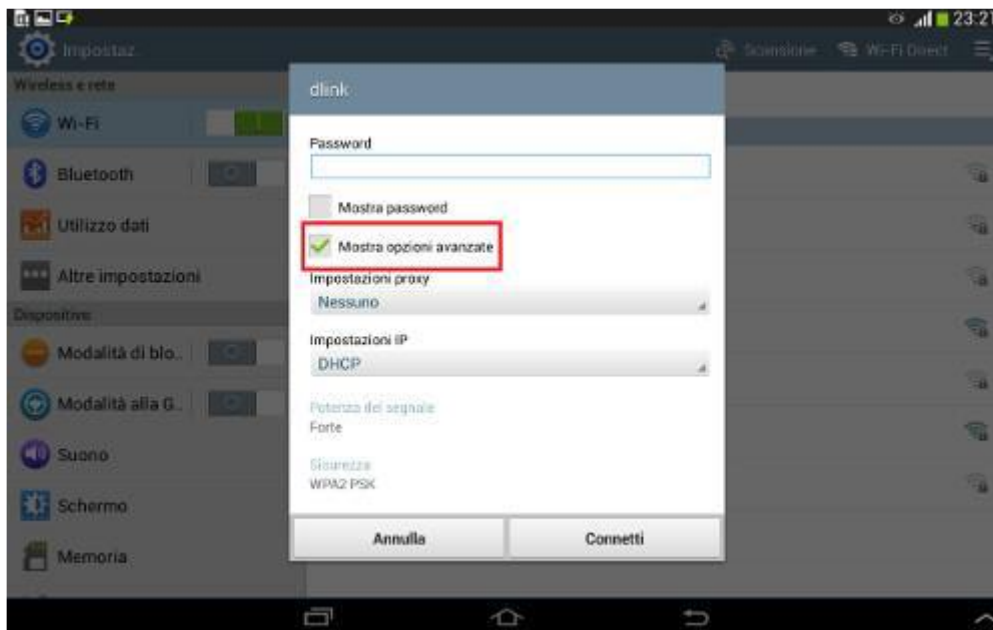

5. On Proxy Settings, click on none and select Manual. Then click Connect

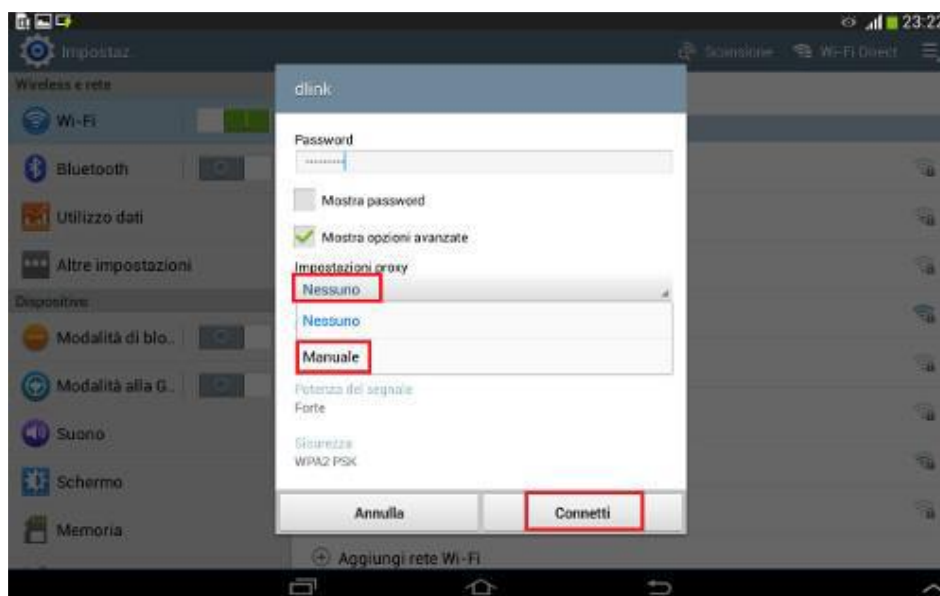

6. Enter the Proxy address



7. Enter the door number



8. As soon as you try to navigate with your browser, you will be asked for UniTO access credentials.